

LIGHTER THAN AIR

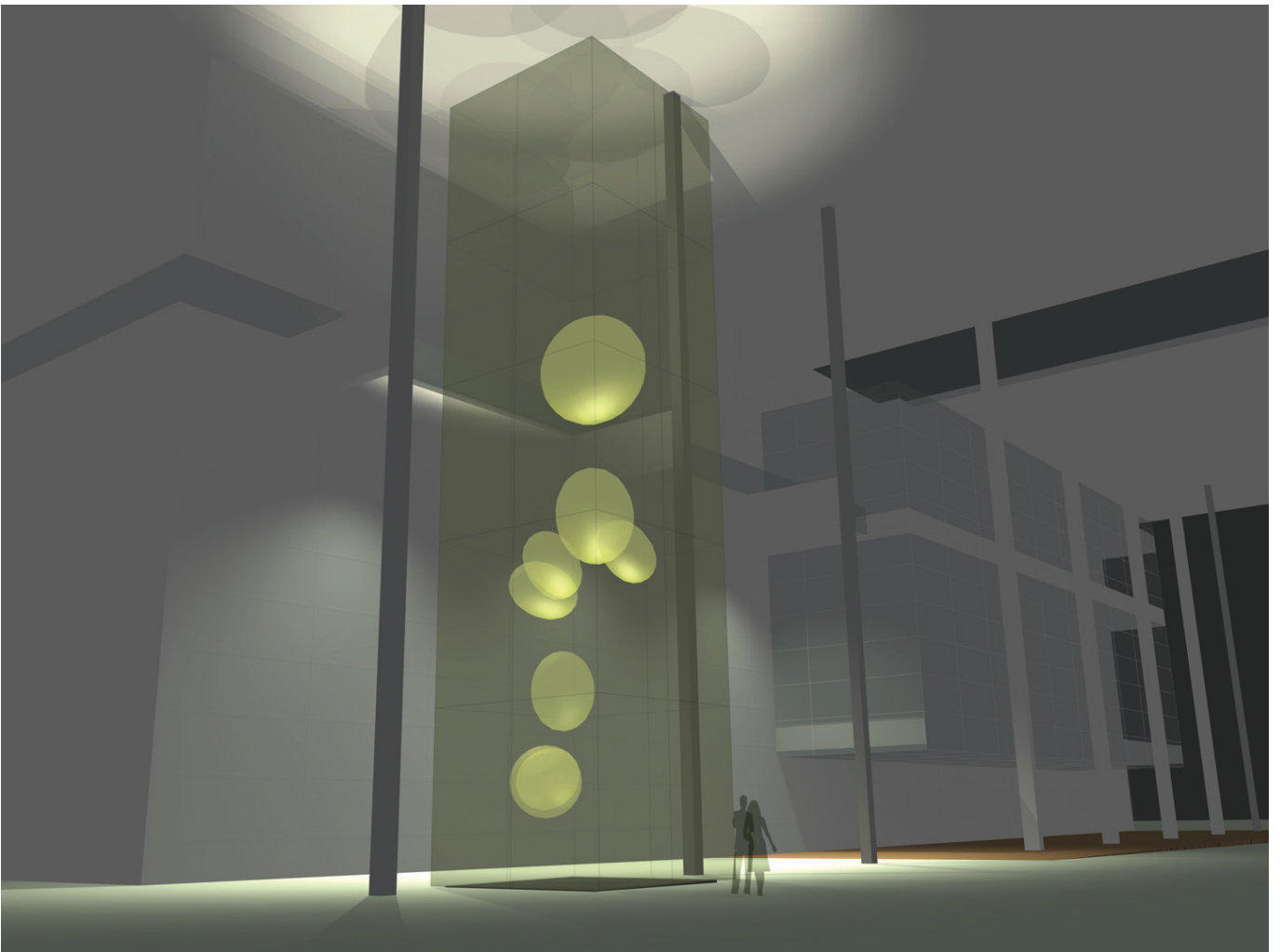

Large light-weight amorphous forms, inflated with a gas lighter than air and weighted to be neutrally buoyant, float adrift in invisible air currents inside a vertical glass box several stories high. In suspended animation, their slow movements create a curious sense of levitation.

Translucent and light in colour, the diaphanous elliptical or spherical forms float in random, weightless levitation. The choreography of these 'heavenly' bodies is unplanned, their orbits are irregular and do not respond to gravitational forces. They respond instead to complex patterns of random air currents. *Lighter Than Air* invites the viewer to share its corporeal lightness and enter into the spirit of its energy, free of weight and unrestrained by gravity.

Artists
Jennifer Turpin

Date
2007

Description
Floating, airborne sculpture

Materials
In Research

Location
Gallery of Modern Art, Brisbane

Client
The State of Queensland

Architect
Architectus